



60 Stanhope Park Road, Greenford, UB6 9LU

£500,000

EVANS
& COMPANY

Stanhope Park Road Greenford

- Semi Detached Bungalow
- 2 Bedrooms
- Own Drive to Garage
- Off Street Parking for 2/3 Cars
- Double Glazed
- Gas Central Heating
- Private Rear Garden
- Walking Distance of Greenford Broadway

Semi detached bungalow located in a popular residential road within a few minutes walk from Greenford Broadway. The property boasts 2 bedrooms, double glazed windows, gas central heating, off street parking for 2/3 cars with own drive to garage.

Entrance Hall
doors to

Bedroom 1
14'6" x 9'10" (4.43 x 3.00)

Bedroom 2
9'2" x 8'4" (2.81 x 2.55)

Lounge
18'0" x 10'5" (5.50 x 3.18)



Kitchen

15'8" x 9'1" (4.80 x 2.77)

Bathroom

Panel enclosed bath, low level wc, wash hand basin, double glaze window to side

Outside

Front

Off street parking for 2/3 cars, Own drive to side providing further parking leading to

Garage

Rear

Patio area leading to lawned area



GROUND FLOOR
506 sq.ft. (47.0 sq.m.) approx.

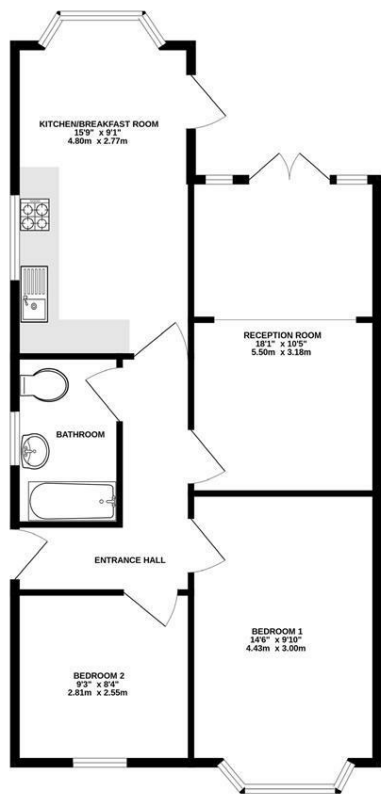

TOTAL FLOOR AREA : 506 sq.ft. (47.0 sq.m.) approx.

Whilst every attempt has been made to ensure the accuracy of the floorplan contained here, measurements of doors, windows, rooms and any other items are approximate and no responsibility is taken for any error, omission or mis-statement. This plan is for illustrative purposes only and should be used as such by any prospective purchaser. The services, systems and appliances shown have not been tested and no guarantee as to their operability or efficiency can be given.
Made with Metropix G2025

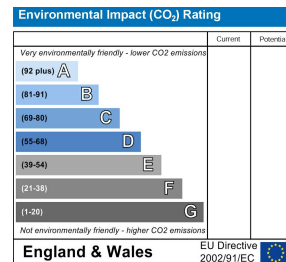
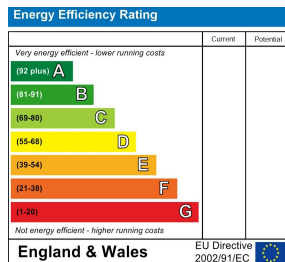

55 The Broadway, Greenford, Middlesex, UB6 9PN
020 8575 7722
enquiries@evanson-line.com
www.altosoftware.co.uk